

Important Note : Oris can also be used horizontal. For horizontal usage; push the diverter with a screwdriver.

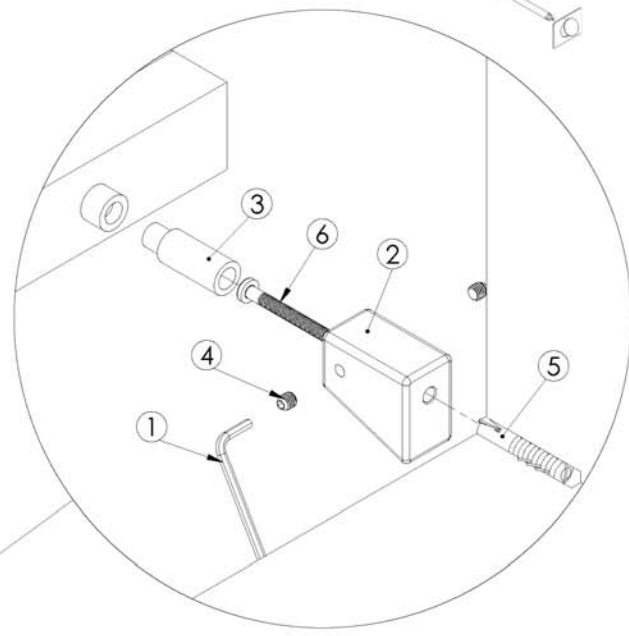

DETAIL A
SCALE 1 : 2

- 1- Allen Key 1 pcs
- 2- Bracket 4 pcs
- 3- Short Pillar Nut 4 pcs
- 4- Grub Screw 8 pcs
- 5- Wall Plug 4 pcs
- 6- Screw, dia 6mm. 4 pcs
- 7- Air Vent 1 pcs
- 8- Blanking Plug 1 pcs

Wall Mounting Instructions:

- 1- According to the relative wall connection axis (L) & (S) drill 4 Nr holes 10 mm.Ø x 50 mm. depth.
- 2- Insert wall plugs (5) into the drilled holes.
- 3- Screw the brackets (2) with the screws (6) into the wall plugs (5).
- 4- The Short Pillar Nuts (3) are screwed into the collectors at the back of the radiator as shown.
- 5- Offer up the radiator and insert the short pillar nuts (3) into the brackets (2).
- 6- Using the allen key (1) provided, retain the short pillar nuts (3) into the brackets (2) with the grub screws (4).

140/160

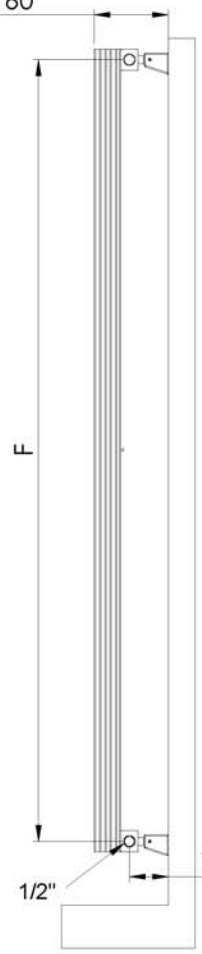

Side View

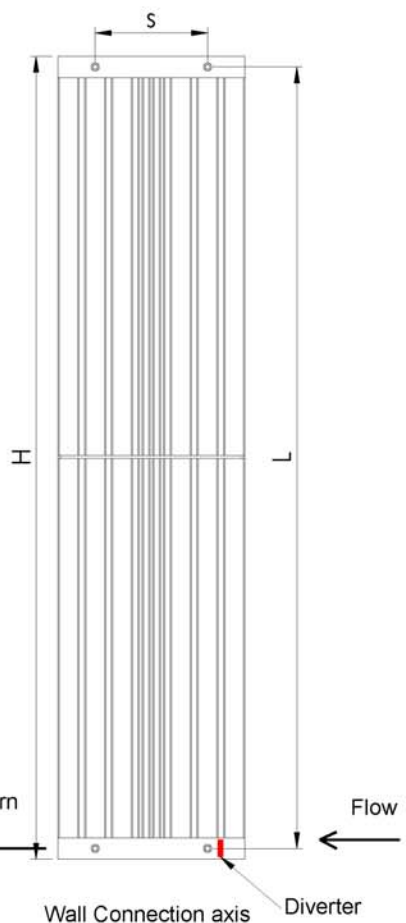

Back View

Note : Flow / Return can not be reserved.
If heating element is installed, push the diverter with a screwdriver.

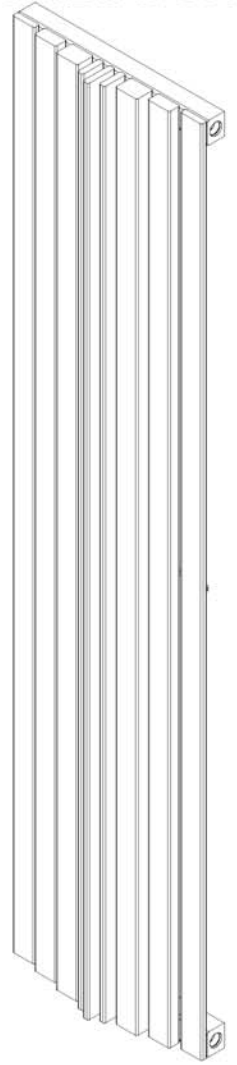
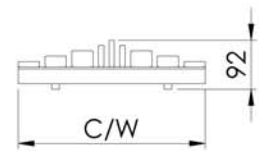

Water Connections : 1/2" BSP

Not suitable for use with direct hot water systems. Not suitable for gravity circulation.

Product Code	Width	Height	Conn. Centers		Assembly Axis		Tube Qty
	W	H	C	F	S	L	
ORIS1500-09	350	1500	350	1460	210	1460	9
ORIS1800-09	350	1800	350	1760	210	1760	9

*All measurements are in millimetres

This publication is issued subject to alteration or withdrawal without notice