

MISTRAL

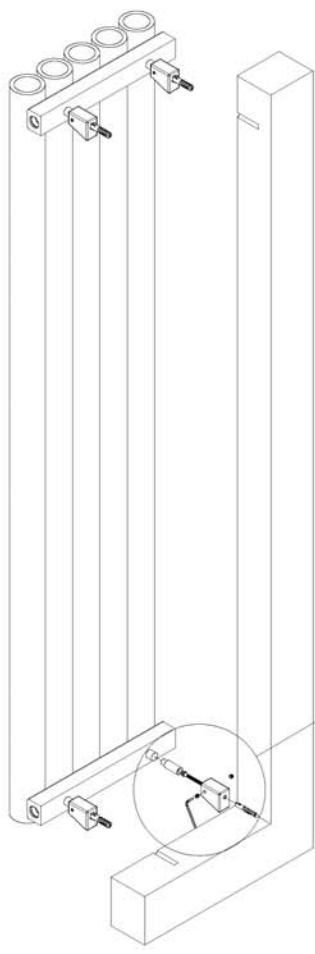

Important Note : Mistral can also be used horizontal. For horizontal usage; push the diverter with a screwdriver.

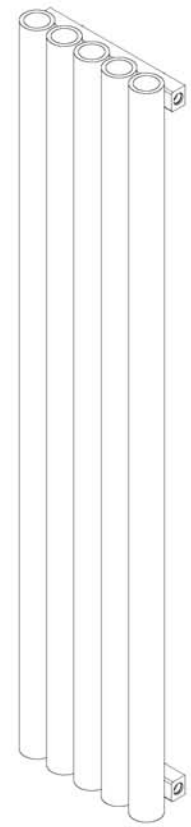
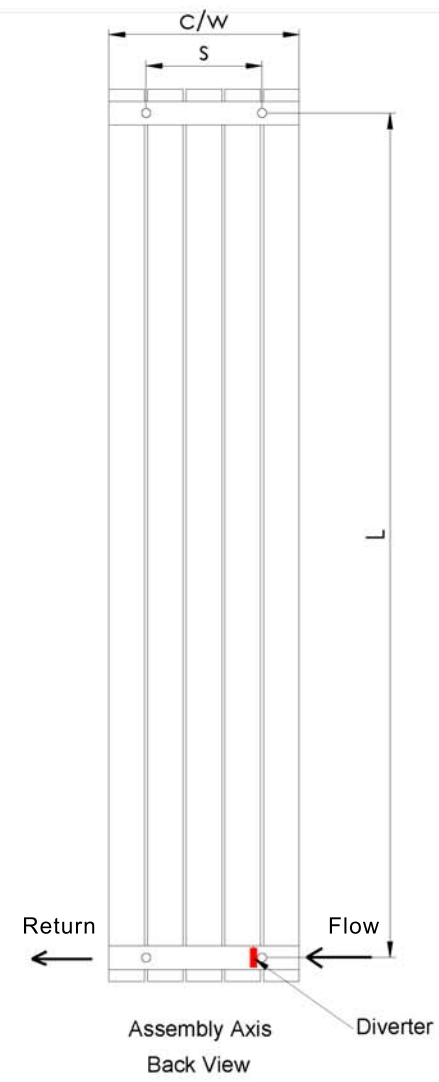
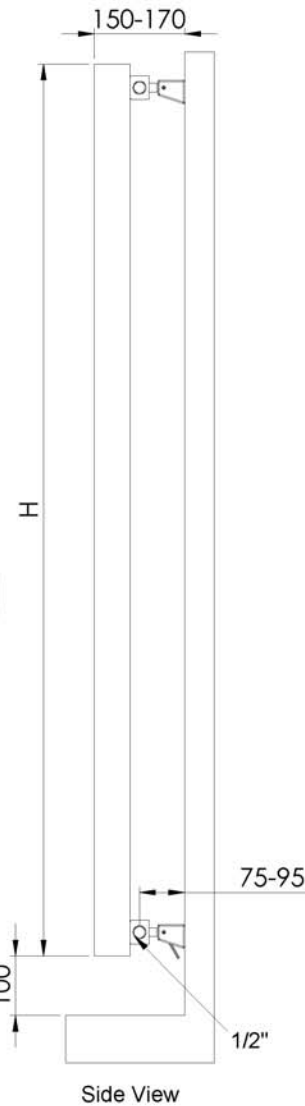
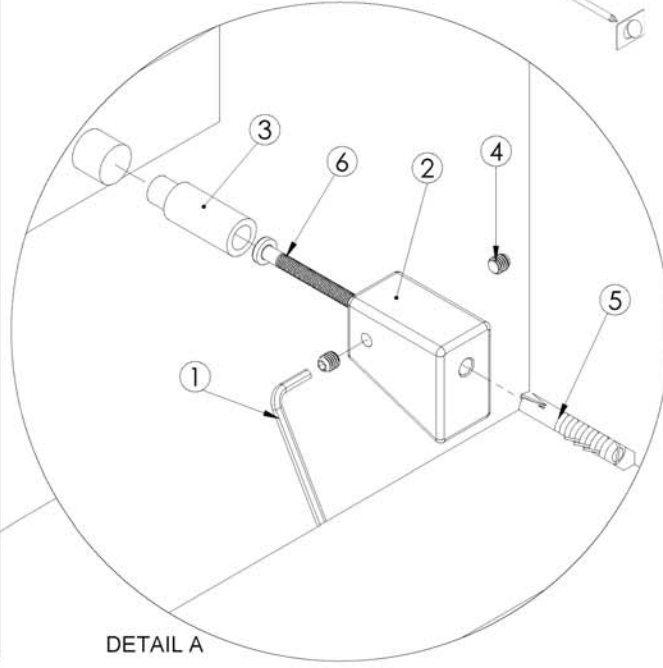

- | | | | |
|----|--|------------------|-------|
| 1- | | Allen Key | 1 pcs |
| 2- | | Bracket | 4 pcs |
| 3- | | Short Pillar Nut | 4 pcs |
| 4- | | Grub Screw | 8 pcs |
| 5- | | Wall Plug | 4 pcs |
| 6- | | Screw, dia 6mm. | 4 pcs |
| 7- | | Air Vent | 1 pcs |
| 8- | | Blanking Plug | 1 pcs |

Wall Mounting Instructions:

- 1- According to the relative wall connection axis (L) & (S) drill 4 Nr holes 10 mm.Ø x 50 mm. depth.
- 2- Insert wall plugs (5) into the drilled holes.
- 3- Screw the brackets (2) with the screws (6) into the wall plugs (5).
- 4- The Short Pillar Nuts (3) are screwed into the collectors at the back of the radiator as shown.
- 5- Offer up the radiator and insert the short pillar nuts (3) into the brackets (2).
- 6- Using the allen key (1) provided, retain the short pillar nuts (3) into the brackets (2) with the grub screws (4).



Note : Flow / Return can not be reserved. If heating element is installed, push the diverter with a screwdriver.

Water Connections : 1/2" BSP
 Not suitable for use with direct hot water systems. Not suitable for gravity circulation.

Product Code	Width	Height	nn. Cent	Assembly Axis		No. Of Tubes
	W	H	C	S	L	
MISS1500-05	320	1500	320	195	1420	5
MISS1800-05	320	1800	320	195	1720	5
MISS1500-07	450	1500	450	325	1420	7
MISS1800-07	450	1800	450	325	1720	7

*All measurements are in millimetres
 This publication is issued subject to alteration or withdrawal without notice